

# ULCO 88

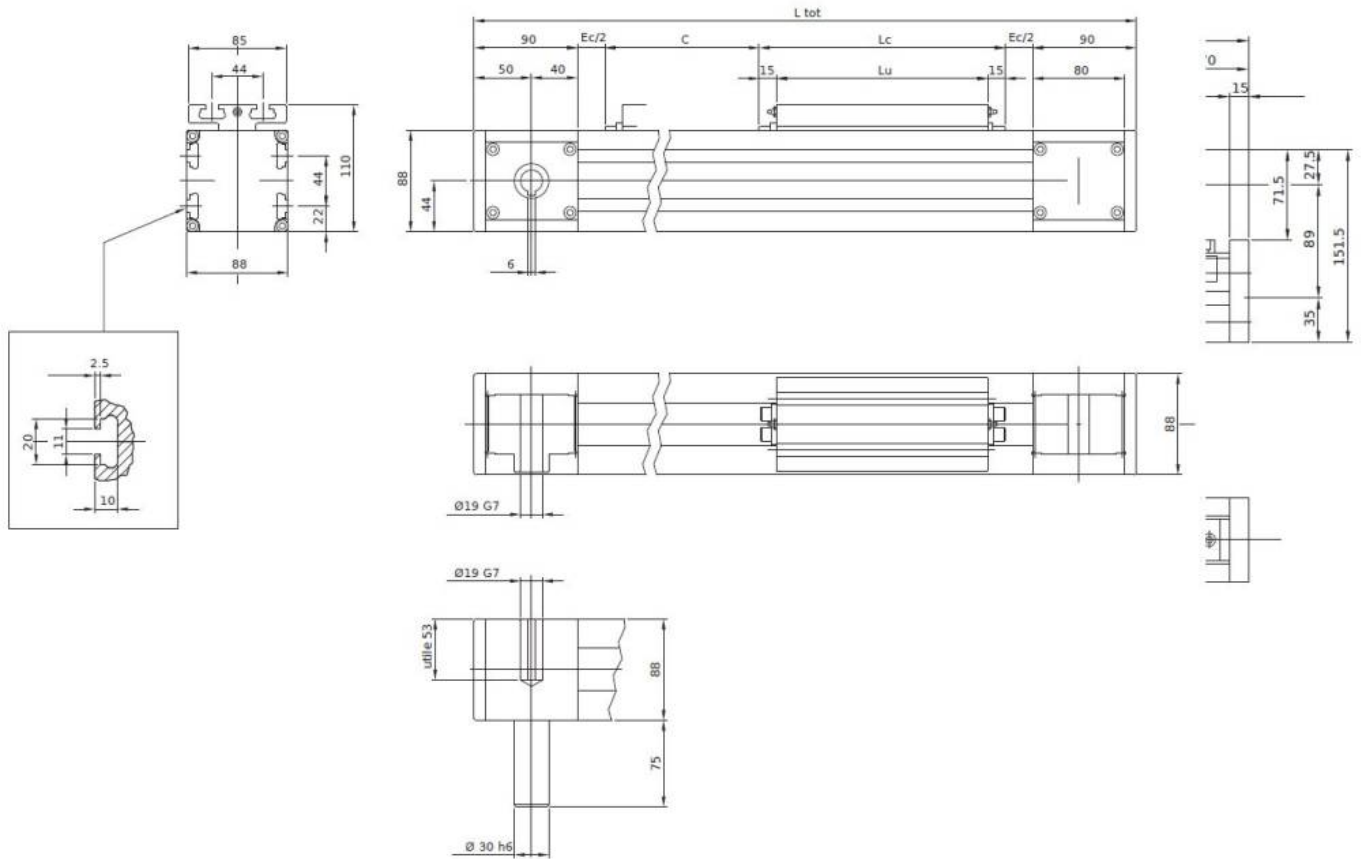

## Mechanical drawing



### Load rating

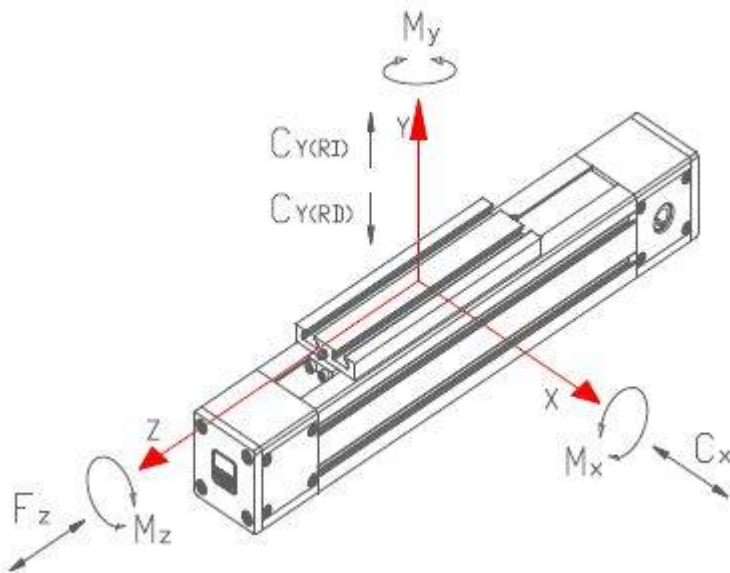

<b>Fz</b> [daN]	<b>Cx</b> [daN]	<b>Cy</b> [daN] (*)	<b>C<sub>ox</sub></b> [daN]	<b>C<sub>oy</sub></b> [daN] (*)	<b>M<sub>ox</sub></b> [daNm]	<b>M<sub>oy</sub></b> [daNm]	<b>M<sub>oz</sub></b> [daNm]
<b>500</b>	<b>4547</b>	<b>4547↓</b> <b>4547↑</b>	<b>7862</b>	<b>7862↓</b> <b>7862↑</b>	<b>766</b>	<b>766</b>	<b>80</b>

## Technical data

Parameter	Symbol	Value	Unit
Max usable stroke		6400	mm
Total lenght	Ltot	C+Lc+240	mm
Carriage length	Lc	300	mm
Carriage usable length	Lu	270	mm
Extra-stroke (safety)	Ec	60	mm
Max speed		250	m/min
Max acceleration		100	m/sec <sup>2</sup>
Position repeatability		< 0.05	mm
Aluminium profile section		88 x 88	mm
Inertia momentum of aluminium profile	Ix	2100259	mm <sup>4</sup>
Inertia momentum of aluminium profile	Iy	2896145	mm <sup>4</sup>
Type of mechanic		linear guide with compact block	
Belt type		Poliuretan HTD-5M-47	
Pulley teeth number		30	
Diameter		76,43	mm
Linear movement per rotation		240	mm
Operating temperature		-20 / +60	degrees

From:

<https://dokuwiki.nilab.at/> - NiLAB GmbH  
**Knowledgebase**

Permanent link:

<https://dokuwiki.nilab.at/doku.php?id=ulco:ulco88>

Last update: **2025/07/24 13:35**

