

# ULCO 66

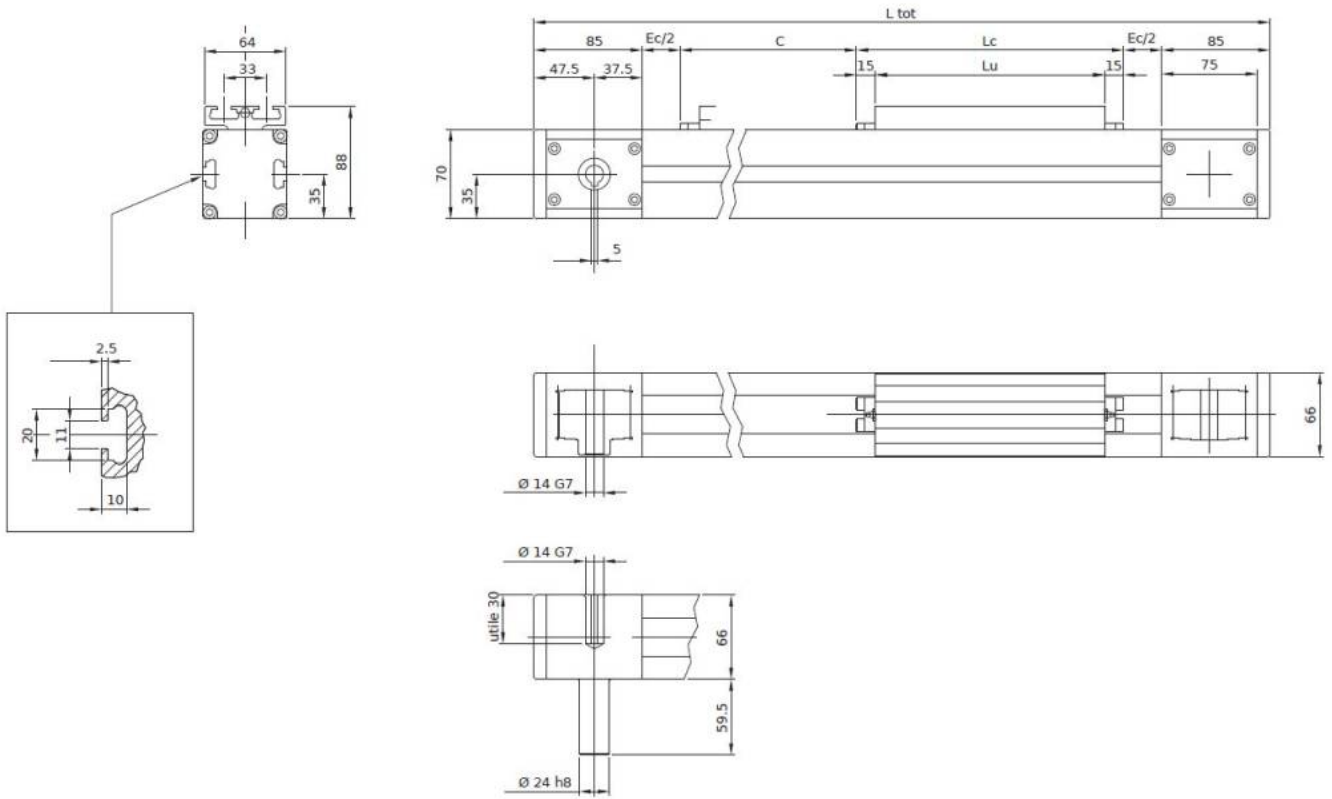

## Mechanical Drawing



## Load rating

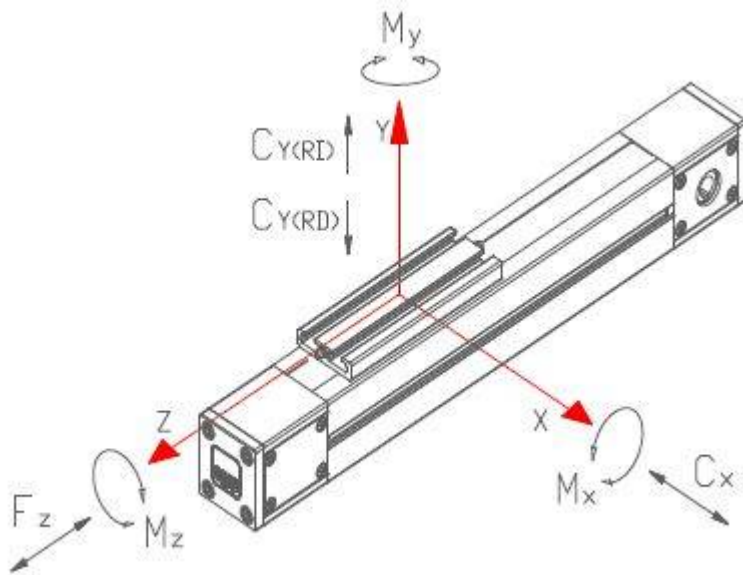

Fz [daN]	Cx [daN]	Cy [daN] (*)	C <sub>ox</sub> [daN]	C <sub>oy</sub> [daN] (*)	M <sub>ox</sub> [daNm]	M <sub>oy</sub> [daNm]	M <sub>oz</sub> [daNm]
220	1904	1904↓ 1904↑	3091	3091↓ 3091↑	253	253	20,2

## Technical Data

Parameter	Symbol	Value	Unit
Max usable stroke		6500	mm

Total lenght	Ltot	C+Lc+230	mm
Carriage length	Lc	250	mm
Carriage usable length	Lu	220	mm
Extra-stroke (safety)	Ec	60	mm
Max speed		250	m/min
Max acceleration		100	m/sec <sup>2</sup>
Position repeatability		< 0.05	mm
Aluminium profile section		66 x 70	mm
Inertia momentum of aluminium profile	Ix	944288	mm <sup>4</sup>
Inertia momentum of aluminium profile	Iy	993457	mm <sup>4</sup>
Type of mechanic		linear guide with compact block	
Belt type		Poliuretán HTD-5M-34	
Pulley teeth number		36	
Diameter		57,32	mm
Linear movement per rotation		180	mm
Operating temperature		-20 / +60	degrees

From:

<https://dokuwiki.nilab.at/> - **NiLAB GmbH**  
**Knowledgebase**

Permanent link:

[https://dokuwiki.nilab.at/doku.php?id=ulco:ulco\\_66](https://dokuwiki.nilab.at/doku.php?id=ulco:ulco_66)

Last update: **2025/07/24 13:24**

